



VANGUARD[®]

FURNITURE

ASSEMBLY INSTRUCTION FOR L101E-MM-P END TABLE

Thank you for purchasing this quality product. Please check all packing materials to ensure proper assembly. Please read all instructions carefully before starting the assembly process. Some parts are large and heavy and require at least two people to assemble, in order to prevent possible injury and/or damage to the piece.

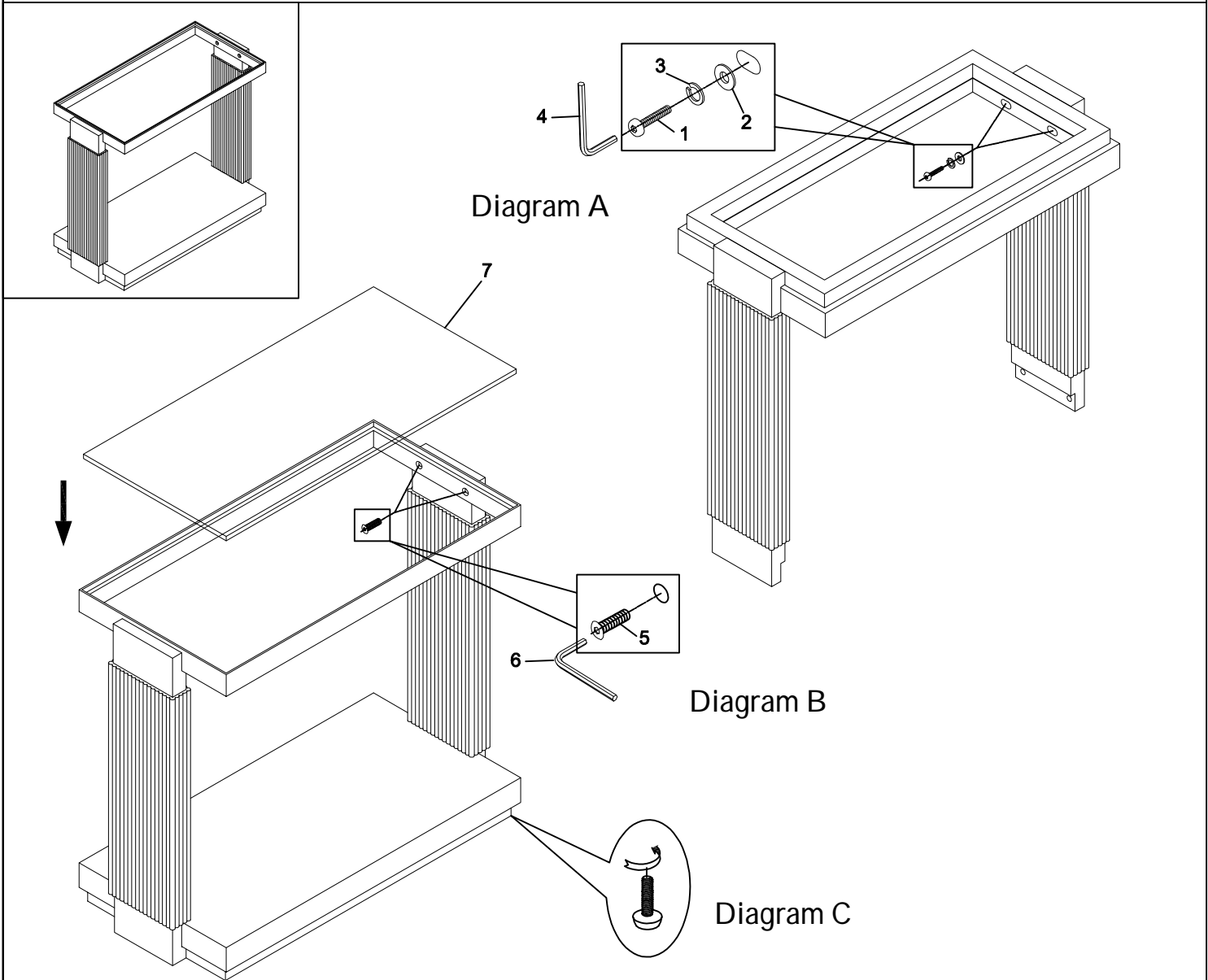

HARDWARE PACK

NO.	DRAWING	DESCRIPTION	SIZE	Q'ty
1		Bolt	Ø5/16*2"	4pcs
2		Flat washer	Ø5/16*19D*1.5	4pcs
3		Lock washer	Ø5/16"	4pcs
4		Allen Wrench	5MM	1pc
5		Bolt	Ø1/4*7/8"	4pcs
6		Allen Wrench	4MM	1pc
7		Glass Top		1pc

ASSEMBLY INSTRUCTION:(TWO PEOPLE REQUIRED)

1. Place base on post then use bolt (1), lock washer (3), flat washer (2) and allen wrench (4) to attach the base to the post. Diagram A
2. Turn the table upright, place metal frame on post then use bolt (5) and allen wrench (6) to attach the metal frame to the post. Diagram B
3. Adjust screw-in levelers as needed and carefully place glass (7) on top of the table. Diagram A

CLEANING INSTRUCTIONS:

Clean surfaces with a clean soft damp cloth.